



Tecumseh



A Legend is Reborn.

Introducing the all-New AE² Next Generation Compressor

REDUCED ENERGY CONSUMPTION

- Most efficient compressor of its size on the market
- Approaching 11 EER with R290 applications

WIDER CAPACITY IN A SMALLER ENVELOPE

- Reduced size envelope covers capacities normally served by larger compressors

ENVIRONMENTALLY FRIENDLY

- Designed for optimal performance with "Green" hydrocarbon refrigerants R290 and R600a
- Supports R134a and R404A

PROVEN RELIABILITY

- Leverages robust design attributes developed from 50-years of AE commercial refrigeration experience

WORLDWIDE PRODUCT OFFERING

- Available across the globe, with flexibility to meet regional needs and agency approvals

SERVICE AND SUPPORT

- Backed by Tecumseh's network of knowledgeable application engineers, test labs & support personnel

SPECIFICATIONS

Product: AE²

Evaporating Ranges: High Back: -10°F to +50°F (-25°C to +15°C)
 Low Back: -40°F to +10°F (-40°C to -10°C)

Refrigerant: R134a, R404A, R290, R600a

Capacity: 1/6 HP through 1/2 HP

Connections: Copper braze suction and discharge connections

Features

Oil: Polyolester (POE)

Footprint: Industry Standard 4.5"x 7.0"

Motor Type: Capacitor Start Run (CSR)
 Capacitor Start Induction Run (CSIR)

Voltages: 115/60/1 230/50/1
 115-127/60/1 220/50/1
 220/60/1 220-240/50/1

Agency Approval Listing: UL®, CE, other approvals available on request

DIMENSIONS

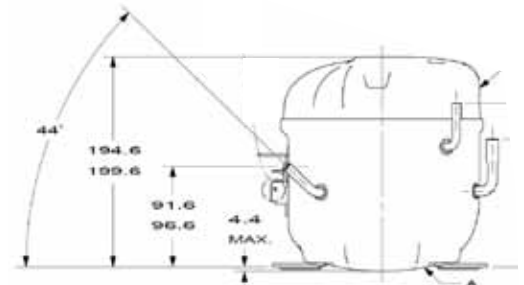
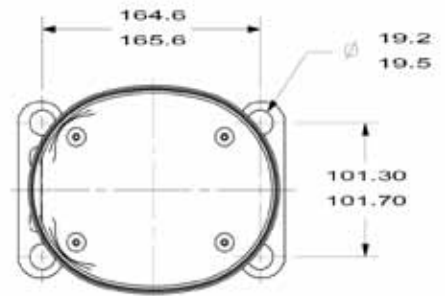

COMPRESSOR MODEL NUMBER

AE 4 440 Y - AA 3 C

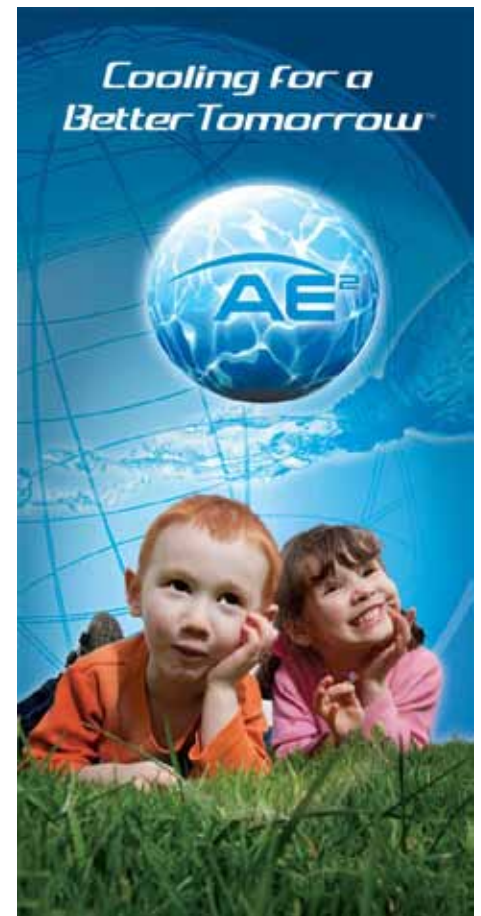
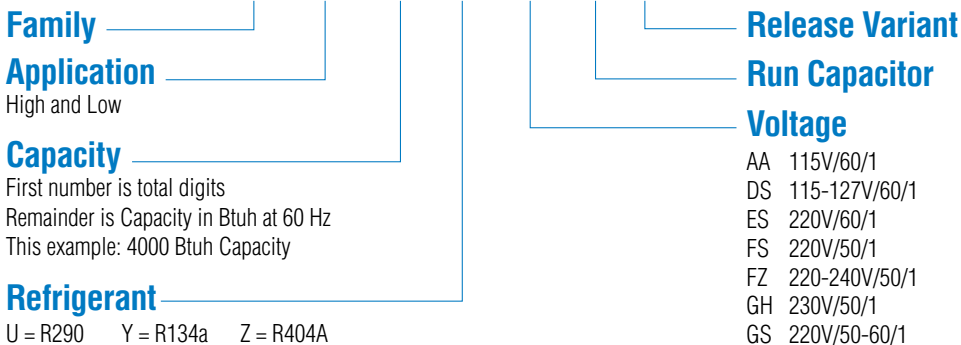

OPERATING ENVELOPE

Refrigerant	Capacity in Btuh (60 Hz, Single Phase)						
	800	1,000	1,500	2,500	5,000	6,000	7,000

High Back Pressure							
R134a							
R290							
R404A							

Low Back Pressure							
R134a							
R290							
R404A							
R600a							